

Dimensioni d'ingombro valvola a sfera con leva manuale
Overall dimensions ball valve with lever

Diam/Size mm ins.	A	B	C	D	E	F	ØG	L	ØM	ØN	PESO WEIGHT Kg.
8 1/4	67	62.5	120	30.5	53	33.5	F03 36	38	11	9	0.56
10 3/8	67	62.5	120	30.5	53	33.5	F03 36	38	11	9	0.53
15 1/2	77	63.5	120	32.7	60.5	38.5	F03 36	38	15	9	0.66
20 3/4	87	75	170	41.5	68	43.5	F05 50	50	20	11	1.14
25 1	105	79.5	170	47	82.3	52.5	F05 50	50	25	11	1.83
32 1 1/4	122.5	93	170	59.5	99.1	61.3	F05 50	50	32	11	2.83
40 1 1/2	138.5	113.5	230	73.9	113.8	69.3	F07 70	70	40	14	4.75
50 2	166	123.5	230	85	139	83	F07 70	70	49.5	14	8.77

Schema di funzionamento - Operating draft

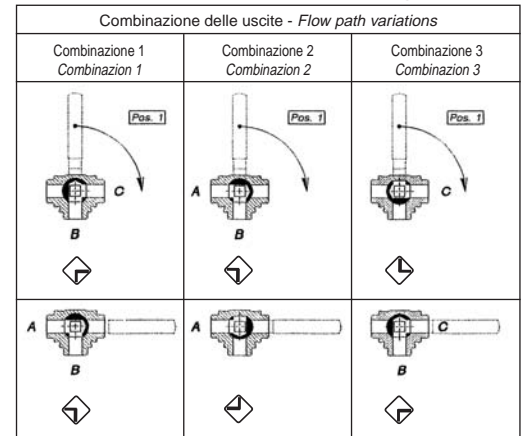

La posizione dei fori della sfera è indicata dalla fresatura dell'asta ↷

The ball holes position is showed on the stem milling ↷

A, B, C = uscite

A, B, C = outlets

Rotazione della leva: 90°

90° Lever rotations

Per variare la combinazione delle uscite procedere come segue:

To change outlets combination please operate as follow:

- Togliere la leva
- Ruotare l'asta nella posizione di partenza desiderata (Posizione 1)
- Rimettere la leva

- Remove the lever
- Turn the stem into the desired starting position (Position 1)
- Reset the lever

Dimensioni d'ingombro valvola a sfera con attuatore pneumatico a doppio effetto
Overall dimensions ball valve with pneumatic actuator - double acting

Diam/Size mm ins.	Modello Model	A	B	C	D	E	F	G	H	I	L	ØM	PESO WEIGHT Kg.
8 1/4	AP0-DA	67	117.5	45	30.5	53	33.5	28.5	22.5	25	110	11	1.14
10 3/8	AP0-DA	67	117.5	45	30.5	53	33.5	28.5	22.5	25	110	11	1.11
15 1/2	AP1-DA	77	144.2	67	32.7	60.5	38.5	41	30	25	137	15	1.81
20 3/4	AP2-DA	87	173.5	83	41.5	68	43.5	44.5	36.5	25	150	20	2.74
25 1	AP2-DA	105	185	83	47	82.3	52.5	44.5	36.5	25	150	25	3.43
32 1 1/4	AP2-DA	122.5	203.5	83	59.5	99.1	61.3	44.5	36.5	25	150	32	4.43
40 1 1/2	AP3-DA	138.5	241.9	100	73.9	113.8	69.3	49.5	42.5	25	204	40	7.55
50 2	AP3-DA	166	265.5	100	85	139	83	49.5	42.5	25	204	49.5	11.57

Connessione per elettrovalvola secondo "NAMUR"

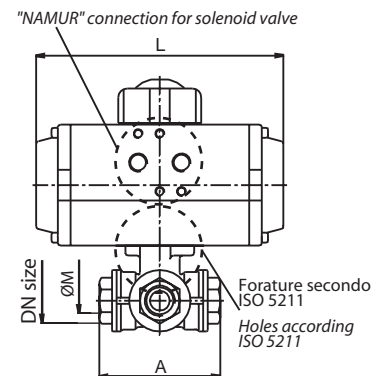

Dimensioni d'ingombro valvola a sfera con attuatore pneumatico a semplice effetto
Overall dimensions ball valve with pneumatic actuator - spring return

Diam/Size mm ins.	Modello Model	A	B	C	D	E	F	G	H	I	L	ØM	PESO WEIGHT Kg.
8 1/4	AP1-SR	67	139.5	67	30.5	53	33.5	41	30	25	137	11	1.83
10 3/8	AP1-SR	67	139.5	67	30.5	53	33.5	41	30	25	137	11	1.80
15 1/2	AP1-SR	77	144.2	67	32.7	60.5	38.5	41	30	25	137	15	1.93
20 3/4	AP2-SR	87	173.5	83	41.5	68	43.5	44.5	36.5	25	150	20	2.99
25 1	AP2-SR	105	185	83	47	82.3	52.5	44.5	36.5	25	150	25	3.68
32 1 1/4	AP3-SR	122.5	220.5	100	59.5	99.1	61.3	49.5	42.5	25	204	32	6.19
40 1 1/2	AP3-SR	138.5	241.9	100	73.9	113.8	69.3	49.5	42.5	25	204	40	8.11
50 2	AP3,5-SR	166	275.5	110	85	139	83	53	49	25	230	50	13.68

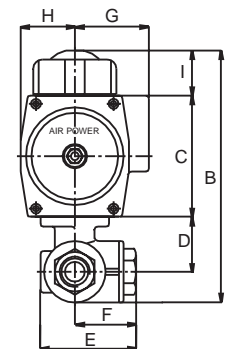

Dimensionamento attuatore:

- alimentazione aria attuatore 5.5 bar (80 psi) min. con un ΔP valvola 16 bar (232 psi) max.

Actuator sizing:

- air supply actuator 5.5 bar (80 psi) min. with ΔP valve 16 bar (232 psi) max.